

Technical Data

EASYLINE® EDGE Line Marking System

Nonfood Compounds
(R2)

No of Pages	8
Issue No	09
Date	07/2021
Ref	NEWHEELMS



Part Code	EASYLINE® EDGE Aerosol Paints 750ml	NSF registration
47000	White	162077
47001	Yellow	162078
47002	Red	162080
47003	Blue	162081
47004	Green	162082
47005	Orange	162083
47006	Black	162075
47007	Grey	162076
47009	Fluorescent Yellow	Not registered
47012	EASYLINE® EDGE Applicator	
47013	Hand-Held Applicator	
47014	Replacement Masking Plates	
	(includes: Masking Plates; Silicone Brushes; Pointer and Central protection plate)	
40141	STENCIL PACK 150mm - UPPERCASE	
40144	STENCIL PACK 300mm - UPPERCASE	

Please refer to the respective technical data sheets for more information www.rocol.com/datasheets

Product Overview

The unique patented EASYLINE® EDGE Line Marking System - easy to achieve professional quality line marking, no additional tools or experience required.

- Ideal for marking factory floors, warehouses, car parks, playgrounds walkways and other hard flat surfaces.
- Produces sharp, clear lines which last up to 2 times longer than the next best competitor*
- Supplied in a heavy duty carry case

The EASYLINE® EDGE Applicator and paint are sold separately.

PLEASE NOTE – The EASYLINE® EDGE Applicator is specifically designed for use with EASYLINE® EDGE Aerosol Line Marking Paint 750ml – NOT compatible with other aerosol brands.



Technical Data

Features and Benefits

EASYLINE® EDGE Applicator

- Battery-powered **Airflow System** produces sharp, clean lines
- **New** and unique Masking plates with Silicone Brushes
 - Even better edge definition and quality.
 - Paint flow is managed consistently for trouble free marking over long distances
 - Non-stick design can be cleaned without solvents.
- Adjustable rear stabilisers with three possible configurations:
 - Wide: for straight line stability
 - Inline: **New** freehand marking feature allows the creation of curves (*minimum radius 0.6 metres*)
 - Curb side: Mark straight lines close to a curbs or racking. (*within 70mm*)
- Now even better over rougher surfaces
 - Wider Track for greater stability
 - Deep rubber tyres all-round
 - Vibration damping in rear wheels
 - Greater ground clearance
- Fully Adjustable line width function. All line widths possible between 50mm, and 100mm.
(*Width setting accuracy +/- 3mm*)
- ROCOL's EASYLINE® EDGE Applicator is quick to assemble and simple to use - no specialist equipment or knowledge required.
- Supplied in a heavy duty carry case for safe storage and transit.
- Included in the box:
 - Wheeled base unit x1
 - Can holder/handle unit x 1
 - 1 x polythene bag containing:
 - AA Battery x 1
 - Spare pair of Masking Plates and Silicone Brushes.
 - Pointer/scraping tool x 1

Supplied with an alkaline battery to get you started that will deliver enough power to spray up to 6 cans. For best performance we recommend the Energizer Ultimate Lithium AA battery which provides 2^{1/2} hours of service; typically, enough to spray 15 cans, or up to 800 metres of a 75mm wide line.

EASYLINE® EDGE Aerosol Paint

- ROCOL EASYLINE® EDGE 'traffic-grade' epoxy paint produces highly durable lines - lasts up to 2 times longer than the next best competitor*
- ROCOL EASYLINE® EDGE lines are quick to apply and dry in 10 minutes, reducing costly 'down-time'
- Safe formula, non-irritant and non-hazardous to the aquatic environment, reduces the hazards to the user and the environment.
- Superior wear resistance compared to other aerosol line marking products
- Excellent covering power
- Available in nine bright colours
- Utilises a unique dual propellant system:
 - More paint and less propellant
 - Consistent quality lines throughout full discharge of the aerosol
 - Consistent quality across a broad temperature range
- Easy to apply with minimal mess and wastage

* Determined by measurement of wear resistance in accordance with ASTM D4060 using a Taber Abraser and a comparison of effects of weathering by UV/condensation cycles in accordance with ISO 11507





NSF registered category code R2.

This product is acceptable for use as a coating where there is no possibility of food contact (R2) such as floors, walls and ceilings. The coating must be applied in a manner which prevents direct or indirect contamination of edible products. Before the food product may be placed in the area where the material is being used, the area should be sufficiently free of odour to prevent product contamination.

Technical Data

Technical Data

EASYLINE® EDGE Applicator

Dimensions boxed: Height: Width: Length: Gross Weight:	<div data-bbox="564 600 651 801"> 30.5 cm 25.5 cm 71.0 cm 7.5 Kg </div> <div data-bbox="805 611 965 790">  </div> <div data-bbox="1029 589 1436 835">  </div>
Recycling Carry case shell Metallic Handle inserts Applicator Large plastic parts	<div data-bbox="564 936 973 1081"> 100% Virgin HDPE - Widely Recyclable Aluminium - Widely Recyclable PA66 GF15 - Recyclable </div> <div data-bbox="1010 936 1050 992">  </div> <div data-bbox="946 992 986 1048">  </div>
Batteries Required	1 x AA For best performance we recommend Energizer Ultimate Lithium AA batteries
Country of Origin	China
Hazard Classification for Transport	Not classified as hazardous for transport by road or sea

Technical Data

EASYLINE® EDGE Aerosol Paint

Pack Size:	750ml Aerosol
Colours:	White [RAL 9016], Yellow [RAL 1023], Red [RAL 3020], Blue [RAL 5017], Green [RAL 6024], Orange [RAL 2009], Black [RAL 9017], Grey [RAL 7045]* and Fluorescent Yellow. *RAL Colours are approximates only
Drying Times (20°C) Touch Dry: Surface Dry: Through Dry: Hard Dry: Vehicular Traffic:	<div data-bbox="616 1859 734 2049"> 10 minutes 30 minutes 70 minutes ~ 4 hours Overnight </div>

Technical Data

Technical Data

EASYLINE® EDGE Aerosol Paint

Maximum Coverage per can: 50mm 75mm 100mm	100 metres 75 metres 55 metres
No Pick-Up Time: ASTM D711 (Representative of light traffic)	30 minutes
Taber Wear Index: ASTM D4060 200µm Wet Film Thickness Load: 1000g/1000cycles/CS10 Abrading wheel at 20°C Cure Time 24 hours (White) 7 days	142 99
Shelf Life:	2 years
Maximum Chemical Resistance: ASTM D5402	7 days
Cross Hatch Adhesion: BS 3900-E6	Very good/excellent
Flexibility: ASTM D522 (Conical Mandrel)	Excellent
Solvent Resistance: (After 7 days)	Resistant to most general chemicals for example: Detergents, Petrol, Diesel and Oil.
Resin Type:	Modified Epoxy Ester
Application Temperature: Surface: Can temperature:	5-30°C 15-25°C
Hazard Classification According to CLP Physico-Chemical Hazards Health Hazards Environmental	Flammable Aerosol Cat.1 Not Classified Not Classified
Hazard Classification for Transport Please Refer to the Safety Data Sheet for more information.	ADR and IMDG UN1950 AEROSOLS, 2.1 Not Dangerous for the Environment Not a Marine Pollutant

Technical Data

Surface Preparation

All surfaces should be clean, dry and dust free before application. Any surfaces covered in heavy grime/grease should be cleaned with a suitable water washable, multipurpose degreaser. Ensure that the surface is thoroughly rinsed and allowed to dry before application.

Steel Surfaces

Clean the surface thoroughly before application. If possible, abrade the surface to improve adhesion.

Concrete

The surface should be cleaned thoroughly before use. All surface latence should be removed. On new or polished concrete, treatment with an acid etch solution is recommended prior to application of EASYLINE® EDGE. Alternatively, mechanically etch the surface by scabbling.

Asphalt

Asphalt should be free from dust, dirt, and grease etc. If necessary, the surface should be cleaned by pressure washing and allowing the asphalt to dry thoroughly before application of EASYLINE® EDGE.

To avoid asphalt bleed on very new tarmac/asphalt surfaces, apply a quick line as a primer and leave to dry for 20 minutes before overcoating.

Timber

Sand the surface to remove any weak timber or contamination. Not suitable for hardwoods with high tannin content or traditional railway sleepers which may result in tannin bleed and poor adhesion.

Painted Surfaces

Caution, perform a small test area before coating. Lightly abrade the surface before application. Check for compatibility. May damage the existing surface. Removal will not be possible without damage to the existing finish.

Assembly Instructions

Assembly Instructions (with reference on next page)

01. Remove the components from the case.
Note: All adjustable or detachable components are colour coded yellow (except red silicone brushes)
02. Note: New Applicators are supplied with the masking plates already fitted.

To re-assemble and attach the masking plates after use:
A&B: First attach the silicone brushes to the pegs on the back of the masking plates. Ensure that the back of each red silicone brush is flush with the back of the masking plate.
03. **C&D:** If desired, fit the pointer to the front of a masking plate. Right-handed people should fit the pointer to the left masking plate as shown.
04. **E:** Attach the assembled masking plates into the wheeled base unit as shown. They should click into place.
F: The complete base unit assembly should look like this.
05. **G:** Insert the AA battery. Slide the yellow battery cover upwards, insert the battery positive end up, push the battery down and in.
06. **H:** Switch on the fans and **I:** check that air is blowing down, behind the masking plates. (Switch off the fans when not in use).
07. **J:** Attach the handle to the base unit and push down until **K:** the yellow buttons click into the 100mm height setting

08. Extend the handle.

L: Depress the small yellow buttons at the base of the handle.

M&N: Pull the handle up until **O:** the yellow buttons re-engage into the fully extended position.

09. Adjust the angle of the handle.

P: Press and hold the yellow button on the hinge and **Q:** pull back the handle to the desired angled before releasing the button.

10. Set the desired line width.

R: First adjust the width by turning the wheel until the desired width is at the edge of the visible gauge. Note the colour zone in which the width setting resides.

S: Then adjust the height of the can holder to the matching colour zone. Pinch the yellow buttons on either side and whilst holding the base unit down with the other hand, slide the can holder to the required position.

[Click here for assembly instruction video](#)

[Watch video](#)

Technical Data

Assembly Instructions

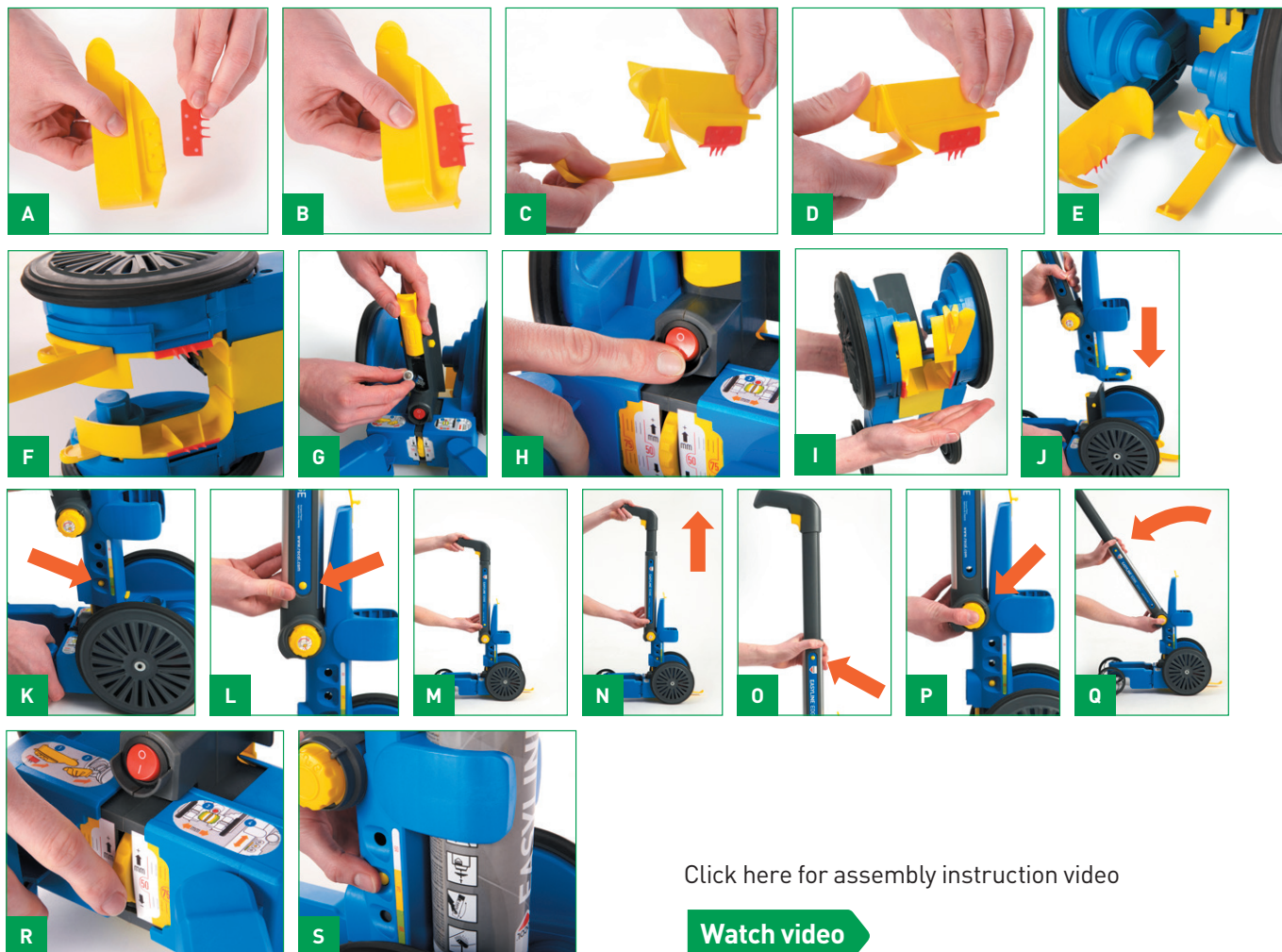

[Click here for assembly instruction video](#)

[Watch video](#)

Preparation of the Aerosol

11. Mix the aerosol contents:

T: Hold the aerosol can upside down and shake it until the mixing balls rattle. Then shake for a further minute.

Caution! Before attaching the yellow spray nozzle, ensure that all orifices are free of paint build up. If any orifice is blocked, discard the actuator. Do not try to remove paint with a pin or other such instrument, as this is likely to damage the actuator and it will not be possible to produce good quality lines. Never insert anything into the valve stem!

12. U: Attach the yellow spray nozzle (supplied with the aerosol), whilst pointing the can up and away from your face and others, position the valve stem into the underside of the nozzle and pull down gently until it clicks into place.

13. V: Invert the can and insert it into the can holder. Rotate the can until the wings of the yellow nozzle locate.

14. W: Ensure that the yellow clip has hooked over the top of the can.



Technical Data

Assembly Instructions

Configure the Rear Stabilisers as Required



Steerable:
Curves or circles



Fully Stabilised:
Straight lines



Half stabilised:
Straight lines close to kerbs or racking

You are now ready to start line marking! Whilst working, remove the can from the applicator every 30mins and re-shake the contents.

Application

ROCOL EASYLINE® EDGE aerosol paint is supplied with two actuators (spray nozzles). Attach the yellow actuator for use with the EASYLINE® EDGE Applicator or attach the white actuator for use with the Hand-Held Applicator for free-hand marking or stencilling.

For optimum performance, the can temperature should be 15 - 25°C, (can temperatures outside of this range will affect line quality).

After Use

Allow the applicator to rest on a piece of card. Remove the aerosol from the applicator. Clear the actuator nozzle and valve by pointing the can away from your face and others and depressing the actuator for 3-5 seconds. Store the can separately in a cool, well ventilated place away from sources of ignition. Do not store in direct sunlight.

Follow the instructions for cleaning the applicator before storing it in its carry case, remove the pointer and detach the handle unit from the base unit. Set the width of the base unit to 60mm, and place in the box. Straighten the handle and collapse the height before placing in the box, (handle with trigger down and into the hole).

Cleaning and Maintenance of the Applicator

Remove the masking plates and centre protection plate. Allow the paint to touch-dry (10 minutes). Remove the silicone brushes from the masking plates before using the scraper tool (back of the Pointer) to remove the paint from the masking plates and centre protection plate. Clean the silicone brushes by gently rubbing the dry paint with paper tissue or a rag.

Over-spray on other parts of the machine can be removed before hardening with the scraper tool and a damp plastic scrubbing pad. Do not allow moisture to enter the battery chamber. Hardened paint can be removed using a paint remover wipe or cleaning solvent and a rag. Avoid contact of solvents with printed diagrams on the base unit and graphics on the handle.

Replacement parts available Masking plates; silicone brushes; pointer and centre protection plate are all included in: **Part Code 47014 Replacement Masking Plates.**

Technical Data

Professional Hints and Tips

- Do not mark out car parking spaces when the car park is in use. Warn people of your planned work. Cordon off the area before working
- Whilst working, rest the applicator over a piece of card with a straight edge when not in use to prevent unwanted marks.
- Use the straight edge of the card to create a sharp start to your lines. Have another piece of card ready at the end of the line for a professional finish.
- To improve hiding power over rough or artificial surfaces, apply a coat of paint in both directions.
- Use a straight edge such as a ladder or a piece of racking to create perfectly straight lines.
- To draw curves:
 1. leave the rear arms in-line, the applicator can be steered.
 2. Create a chalk line inside the intended curve with a radius 50mm shorter. Instead of using the pointer, track the front wheel, inside the curve, over the chalk line,
- To avoid poor adhesion, do not paint over moss, surface frost, morning dew, wet surfaces or when raining.
- If the spray is not falling equally between the two masking plates, use the adjuster ring to centralise the spray pattern.

Warning

- Aerosols are pressurised vessels and should be stored and handled with care.
- Protect from sunlight and do not expose to temperatures exceeding 50°C.
- Do not spray onto a naked flame or any incandescent material.
- Do not pierce or burn even after use.
- If the aerosol valve becomes blocked never insert an object into the valve stem!
- Be sure to install the battery correctly, observing the polarity (+/-) signs
- Do not attempt to recharge the battery, do not open or dispose of in a fire, and do not mix with used or other battery types: may explode, leak and cause damage.

Health & Safety

For professional users only. Use outdoors or in a well-ventilated area. Not suitable for use in explosive atmospheres. Not suitable for use in explosive atmospheres.

Refer to the Safety Data Sheet before use. Data Sheets can be found on www.rocol.com/datasheets